

Vihula Manor Country Club & Spa

by Unique Hotels

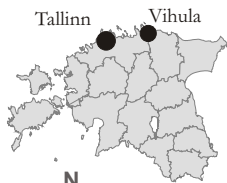

Nature trail
Matkarada 1,5 km

Nature trail
Matkarada 3 km

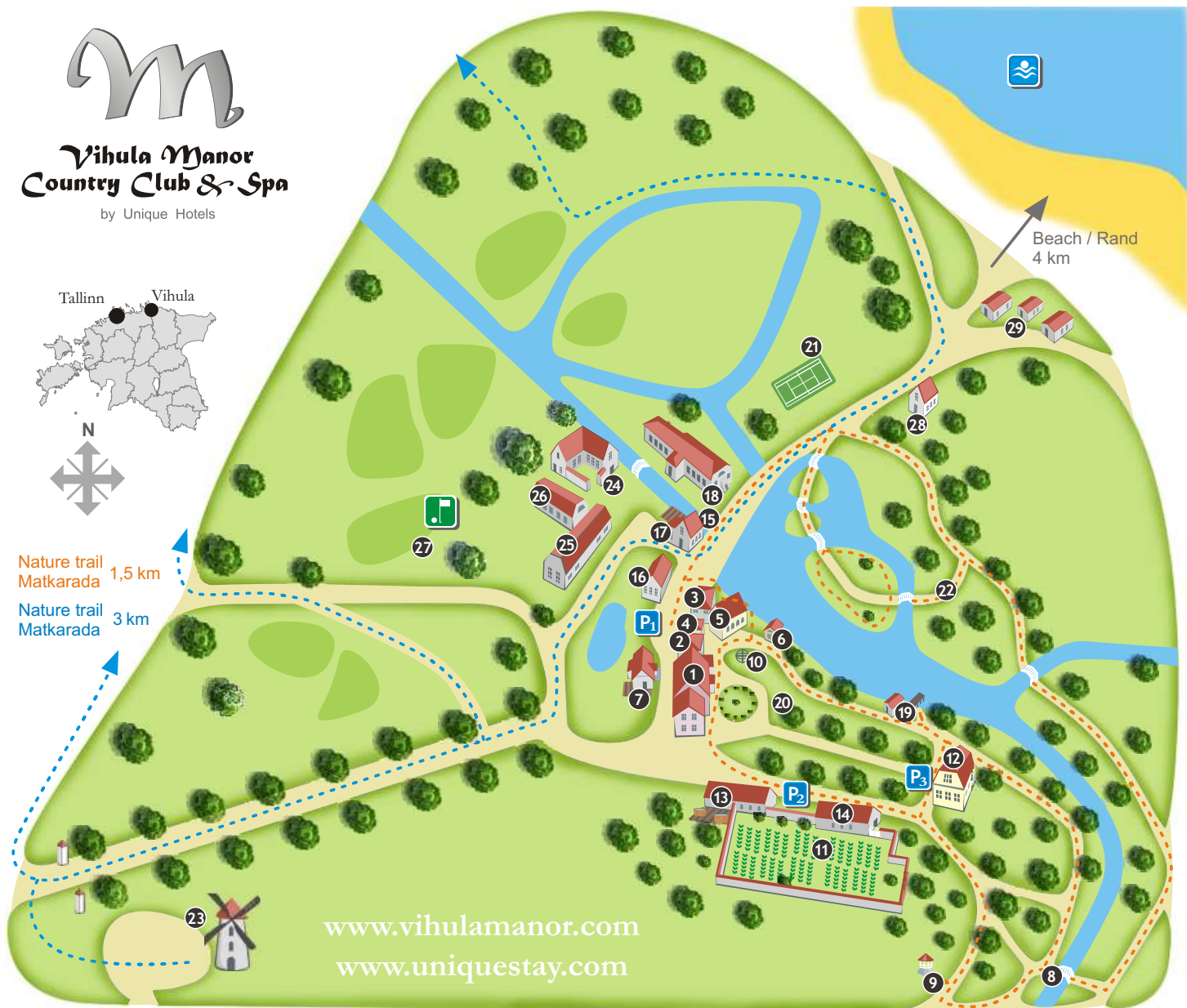

www.vihulamanor.com
www.uniquestay.com

P₁ for restaurant guests / restorani külastajatele

P₂ for spa & hotel guests / spaa ja hotelli külastajatele

P₃ for hotel guests / hotelli külastajatele

- 1) **Main Manor House** - Reception, Reception Lounge, Board Room, Wine Cellar, "La Boheme" Restaurant & Cocktail Lounge, Drawing Room and Library, Cigar Lounge, Sun Terrace, guests rooms no. 24-28 and 45-47
- 2) **Pigeon House** - Guest rooms no. 13-18
Tuvimaja - Külalistetoad nr. 13-18
- 3) **Laundry House** - Guest rooms no.19-23
Pesuköök - Külalistetoad nr. 19-23
- 4) **Oil Granary** - Seminar room
Õliait - Seminariruum
- 5) **Palm House** - Conference and banquet room
Palmimaja - Konverentsi- ja banketisaal
- 6) **Tea House** - Meeting and banquet room
Teemaja - Seminari- ja banketiruum
- 7) **Ice Cellar** - "Kaval-Ants" Tavern, von Schubert's Wine Bar & Terrace
Jääkelder - "Kaval-Antsu" kõrts, von Schuberti veinibaar & terrass
- 8) **Devil's Bridge / Kuradisild**
- 9) **Kissing Tower** - Wedding & viewing
Musitorn - Vaateplatvorm ja pulmatseremooniad
- 10) **Sundial / Päikesekell**
- 11) **Organic Garden, Green House and Kids' Playground**
Aed, kasvuhoone ja laste mänguväljak
- 12) **Back Manor** - Guest rooms no. 01-12
Tagamõis - Külalistetoad nr. 01-12
- 13) **Carriage House** - Eco-SPA Center,
Guest rooms no. 29-36
Tõllakuur - Öko-SPA, külalistetoad nr. 29-36
- 14) **Barn House** - Conference Center,
guest rooms no: 37-44
Ait - Konverentsikeskus, külalistetoad nr. 37-44
- 15) **Waterfall / Kosk**
- 16) **Flour Miller's House** - Post office, administration
Möldrimaja - Postkontor, administratsioon
- 17) **Watermill** - Visitor's Center, gift and design shop,
museum, cafe & terrace (opening 2011)
Vesiveski - Külustuskeskus, kingituste- ja disainipood, muuseum, kohvik & terrass (avatakse 2011)
- 18) **Distillery** - Guest rooms (opening 2012)
Viinavabrik - Külalistetoad (avatakse 2012)
- 19) **Boat House / Paadimaja**
- 20) **Yard Cellar / Õuekelder**
- 21) **Sport Arena**: tennis, football, basketball, volleyball, ice-skating
Spordiväljak - Tennis, jalgpall, korvpall, võrkpall, liuväli
- 22) **Nature trails / Loodusrajad**
- 23) **Windmill / Tuuleveski**
- 24) **Blacksmith's House** - Leisure center, saunas (opening 2011)
Sepikoda - Puhkeskeskus, saunad (avatakse 2011)
- 25) **Cattle Barn** - multifunctional venue for large summer events (opening 2012).
Karjalaut - Multifunktsionaalne suviste suurürituste ala (avatakse 2012)
- 26) **Horse Stable / Hobuste tall**
- 27) **Golf Practice Field / Golfi harjutusväljak**
- 28) **Shop / Pood**
- 29) **Blacksmith's Lodge / Sepa elamu**
- 30) **Parking areas / Parkimine**

